

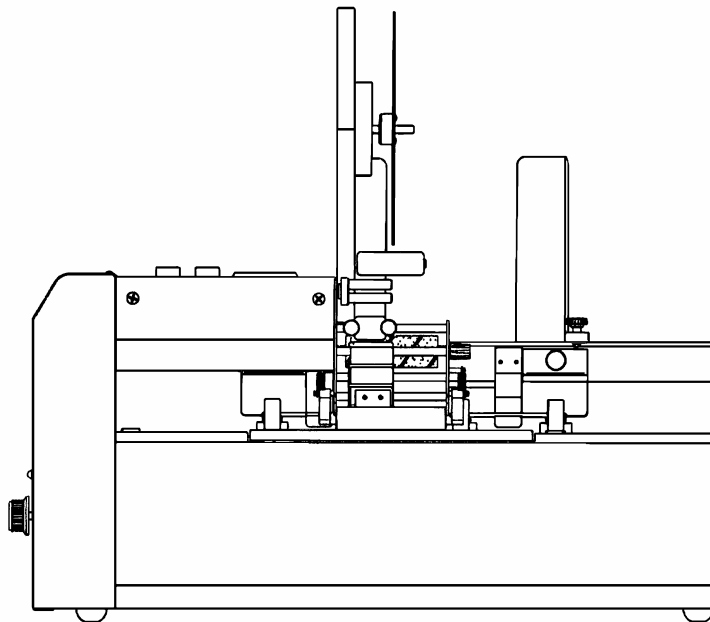

ATS-8000

TABBER



**QUICK START INSTRUCTIONS /
PARTS CATALOG**

SAFETY PRECAUTIONS

THIS EQUIPMENT PRESENTS NO PROBLEM WHEN USED PROPERLY. HOWEVER, CERTAIN SAFETY RULES SHOULD BE OBSERVED WHEN OPERATING THE ATS-8000

READ THIS MANUAL CAREFULLY AND FOLLOW THE RECOMMENDED PROCEDURES:

1. Keep hands, hair, and clothing clear of rollers and other moving parts.
2. Always turn off machine before making adjustments, cleaning the machine, or performing any maintenance not covered in this manual.
3. Turn power off when not in use.

CAUTION

THIS EQUIPMENT MUST BE CONNECTED TO A PROPERLY GROUNDED OUTLET. FAILURE TO DO SO CAN CAUSE ELECTRIC SHOCK!

SPECIFICATIONS

MODEL ATS-8000 TABBER

DIMENSIONS:	21 3/4" W x 19 1/2" H x 8 1/2" L
SPEED:	Fixed speed – 12,000 per hour (8 1/2" x 11" tri-folds)
MEDIA SIZE:	Length - 3" min., 18" max. Width – 5" min., 17" max.
MEDIA THICKNESS:	1/8".
TAB SIZE:	LENGTH – 5/8" TO 1 1/4" (standard tabs)
LABEL SENSITIVITY CONTROL:	Adjusts for density in tab/wafer seals.
REEL CAPACITY:	5,000 tabs
COUNTER:	5 digit LCD
FEEDER:	Top load, bottom feed for continuous operation
SHIPPING WEIGHT:	44 lbs.
ELECTRICAL:	110V, 50/60Hz, 1 AMP 220V, 50/60Hz, .5 AMP

OPTIONAL MODEL ALS-900 CONVEYOR DELIVERY

DIMENSIONS:	11.5" x 18" L x 4" H
SPEED:	Variable 0 - 180 inches per minute
ELECTRICAL:	110 VAC 60 Hz, 0.5 Amp (220 VAC 50/60 Hz available)
SHIPPING WEIGHT:	16 lbs / 7.5 kg

ATS-8000 QUICK-START INSTALLATION

SETTING UP AS A STAND-ALONE TABBER

1. Remove all packing and parts supplied. Check and identify all parts with the ones listed below.

- | | | |
|---|---------------------------|----------------------|
| ✓ | MEDIA GUIDES | 62-105-10 |
| | | 62-105-11 |
| ✓ | STACK REST | 62-100-10 |
| ✓ | MEDIA SUPPORT | 90-102-13 |
| ✓ | THUMBSCREWS | 62-100-50 |
| ✓ | TRACK ROLLER ASSEMBLY | 62-104-00 (4 ROLLER) |
| | | 62-100-48 (2 ROLLER) |
| ✓ | METERING BRACKET ASSEMBLY | 62-100-47 |

2. Attach MEDIA GUIDES (Fig. 2).
3. Install METERING BRACKET ASSEMBLY (Fig. 1,2, and 2A).
4. Install TRACK ROLLERS [2 ROLLER] (Fig. 2).
5. Install MEDIA SUPPORTS and STACK RESTS (Fig. 2).

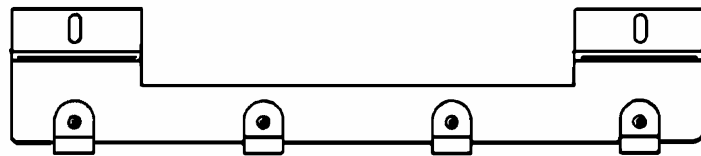

Figure 1 METERING BRACKET ASSEMBLY

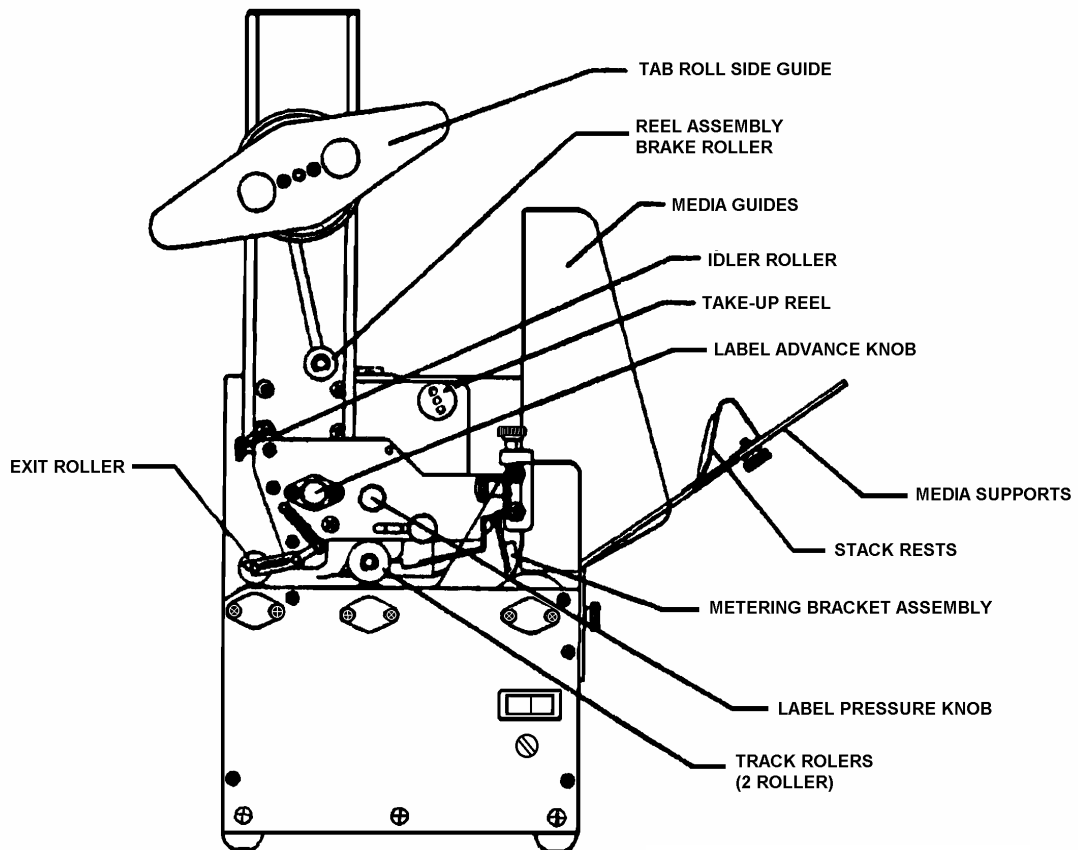

Figure 2

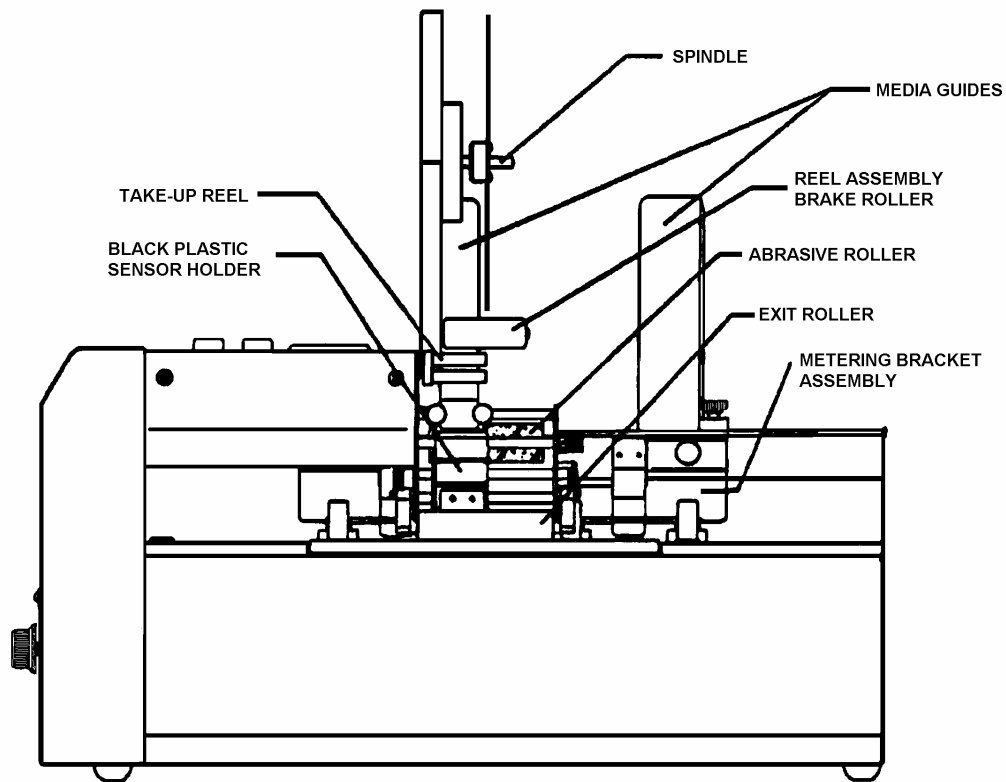

Figure 2A

SETTING UPS AS IN-LINE TABBER

1. Remove MEDIA GUIDES (Fig. 2 and 2A).
2. Remove METERING BRACKET ASSEMBLY (Fig. 1,2, and 2A).
3. Remove MEDIA SUPPORTS (Fig. 2.)
4. Remove TRACK ROLLERS [2 roller] (Fig. 2).
5. Install TRACK ROLLERS [4 roller] (Fig. 3 and 4).

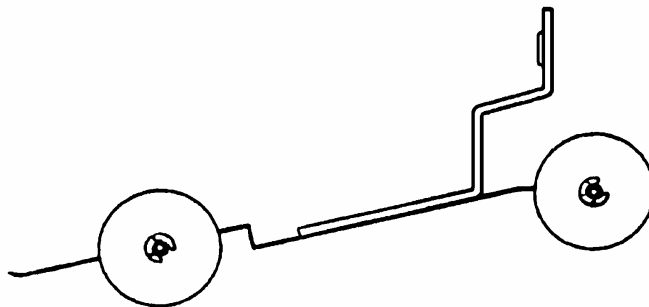

Figure 3 TRACK ROLLERS (4 ROLLER) 62-104-00

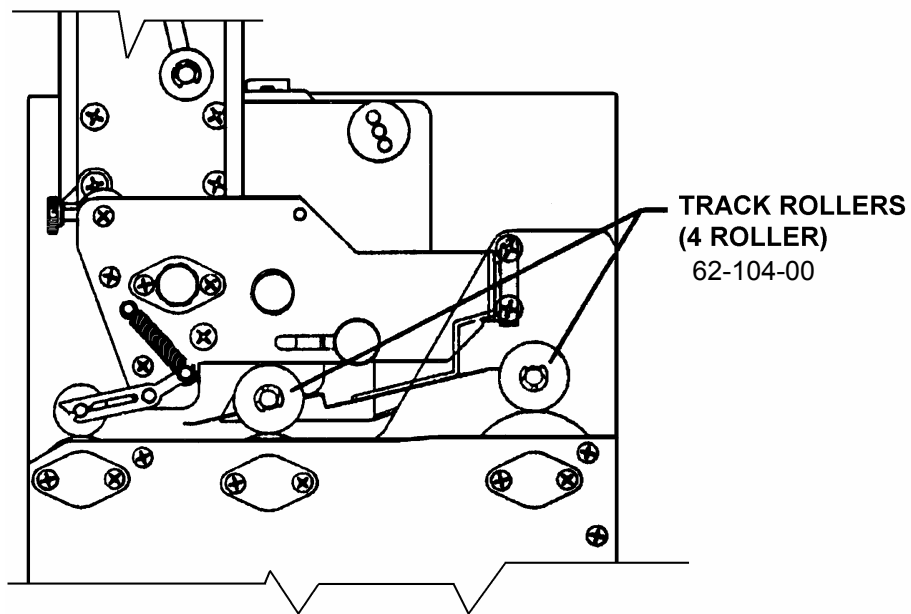

Figure 4

OPERATING INSTRUCTIONS

LOADING TABS

1. Remove TAB ROLL SIDE GUIDE (Fig.5).

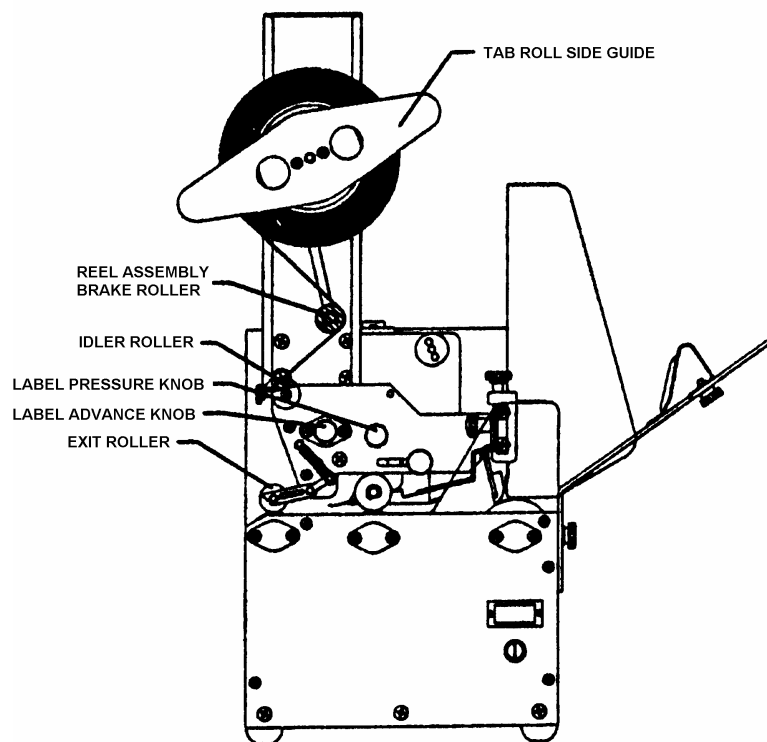

Figure 5

2. Place roll of tabs on SPINDLE (Fig. 5A).
3. Reinstall TAB ROLL SIDE GUIDE.
4. Remove approximately 10" of tabs from backing paper.
5. Remove EXIT ROLLER (Fig. 5).
6. Thread tab stock behind REEL ASSEMBLY BRAKE ROLLER (fig. 5) and in front of IDLER ROLLER (Fig. 5).
7. Thread tab stock through BLACK PLASTIC SENSOR HOLDER (fig. 5A) until stock exits the front for the machine. Bend backing paper and thread it through metal lip (Fig. 5B) until it touches ABRASIVE ROLLER (Fig. 5A).
8. With LABEL PRESSURE KNOB **ON**, use LABEL ADVANCE KNOB (Fig. 5) to advance tabs until tab begins to peel.
9. Bring TAB ROLL SIDE GUIDE into place.
10. Place backing paper into TAKE-UP REEL (Fig. 5A).

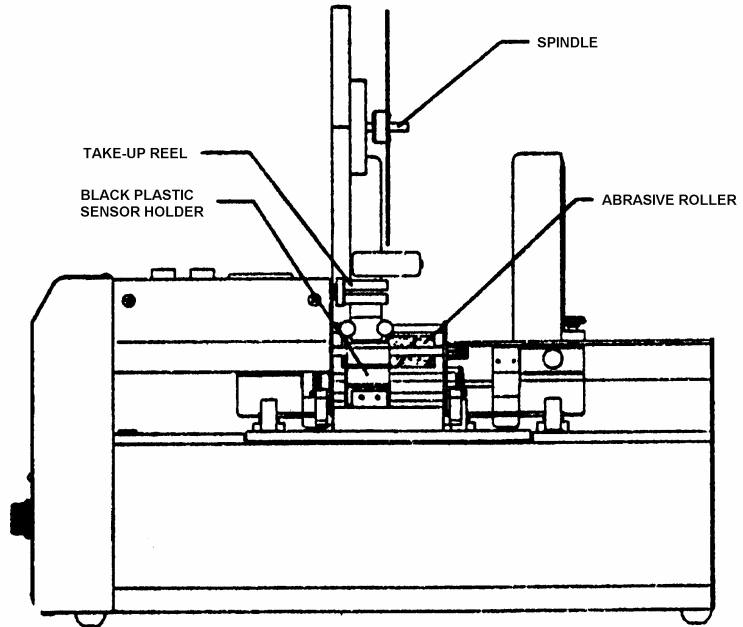

Figure 5A

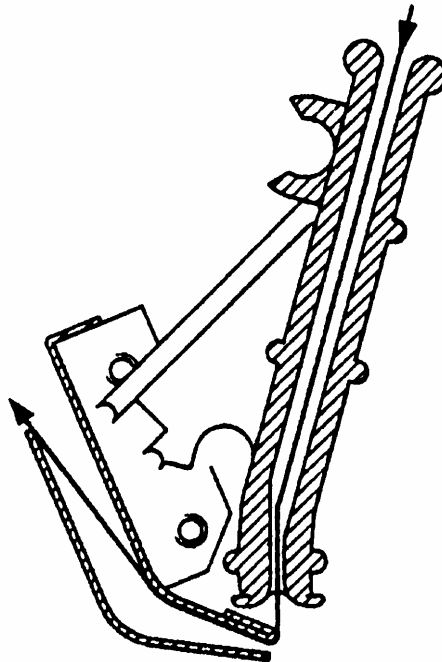

Figure 5B

SETTING TAB SENSITIVITY ADJUSTMENT

1. With tab exposed, turn power switch to **ON**.
2. Turn knob on rear of machine all the way counterclockwise (A, Fig. 6). Now turn one click at a time clockwise until the LED (B, Fig. 6) comes on.
3. Turn LABEL PRESSURE (Fig. 5) **OFF** and roll tabs backward until just backing paper is visible in sensor holder. Turn one click at a time clockwise until LED comes on. Counting the clicks, turn counterclockwise half the number that you just counted. (Example: the LED illuminates for the first time at position four and a second time at position 10. The difference between the two positions is six clicks. Turn back half that number or 3 clicks to position 7).

NOTE: If adjusting knob exceeds number of positions on switch without illuminating LED, then proceed as it were illuminated. If you have an odd number difference, (for example 7 clicks then begin with the lowest number, 3. If double tabbing occurs then click one more time to four).

4. With LABEL PRESURE **ON**, use LABEL ADVANCE KNOB (Fig. 5) to advance until tab starts to peel away from backing paper.
5. Reinstall EXIT ROLLER.

LABEL SENSOR ADJUSTMENT

THE UNIT HAS BEEN FACTORY CALIBRATED TO DETECT THE PRESENCE AND ABSENCE OF LABELS UNDER MOST CONDITIONS. HOWEVER, WITH THE VARIATION OF BOTH LABEL DENSITY AND BACKING PAPER DENSITY IT MAY BECOME NECESSARY TO ADJUST

ADJUSTMENT

1. LOCATE THE SENSOR ADJUSTMENT SWITCH AND L.E.D. (LIGHT EMITTING DIODE) ON THE NON-OPERATOR SIDE COVER. TURN THE SWITCH FULLY COUNTER-CLOCKWISE TO POSITION "1".
2. THREAD LABELS FOLLOWING THE DIAGRAM (FIGURE 6, OR 6A) IN THE INSTRUCTION BOOK.
3. TURN THE LABEL ADVANCE KNOB UNTIL THE FIRST LABEL (OR TAB) JUST STARTS TO PEEL OFF THE BACKING PAPER.
4. TURN THE SENSOR ADJUSTMENT KNOB CLOCKWISE UNTIL THE RED L.E.D. IS ILLUMINATED.
5. RELEASE THE LABEL PRESSURE ROLLER (TURN IT OFF) AND PULL THE LABEL MATERIAL BACK OUT OF THE MACHINE ABOUT TWO INCHES. THIS IS TO ENSURE THAT THE BACKING SHEET IS THE ONLY PART THAT IS BEING LOOKED AT BY THE LABEL SENSOR. THE RED L.E.D. AT THIS TIME WILL NOT BE ILLUMINATED.
6. TURN THE SENSOR SWITCH CLOCKWISE COUNTING THE NUMBER OF CLICKS THE SWITCH MAKES UNTIL THE RED LIGHT COMES ON.
7. TURN THE SWITCH BACK COUNTER-CLOCKWISE ONE HALF THE NUMBER OF CLICKS (POSITIONS) THAT YOU COUNTED. FOR EXAMPLE: LIGHT FIRST CAME ON AT POSITION 9. REMOVE THE TAB FROM IN FRONT OF THE SENSOR AND TURN THE SWITCH 6 CLICKS. LIGHT COMES ON. NOW TURN THE SWITCH THREE POSITIONS BACK.

THE UNIT IS NOW CALIBRATED TO THIS TYPE OF LABEL.

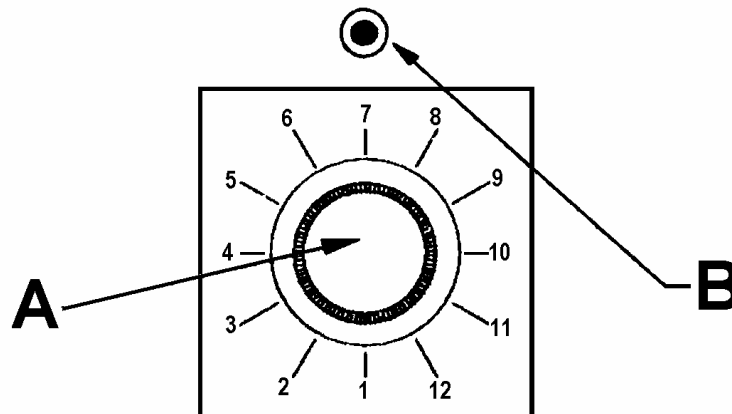

Figure 6

USING AS STAND-ALONE TABBER

1. Set up stand-alone tabber.
2. Position mail piece side to side where tab is desired.
3. Slide MEDIA GUIDES (Fig. 2A) into place.
4. Position STACK RESTS (Fig. 2) under mail piece. Position MEDIA AUPPORTS (Fig. 2) so that back edge of mail piece is in the middle of the support.
5. Place one mail piece on feed roller so that the plastic separators are over the piece. Loosen thumbscrews so tips fall on the mail piece. Tighten thumbscrews.
6. Push tab button down followed by feed button. Check position of tab side to side. Adjust if necessary by moving side guides.
7. Run one more mail piece through then check the tab position top to bottom. Adjust if necessary with thumbscrew under and to the right of the LABEL ADVANCE KNOB (Fig. 2).
8. You are ready to start tabbing.

USING AS IN-LINE TABBER

1. Set us as in-line tabber.
2. Position in-line tabber next to machine you are using. To adjust side-to-side position, move either tabber or other machine.

OPERATING HINTS

1. Fan out the media before use.
2. After loading the media, tap the stack lightly to keep it straight between the guides.
3. If doubles occur, check the stripping device for proper pressure setting.
4. Straighten out excessively curled media.

CONTROL PANEL FUNCTIONS

- A. ON-OFF Power Switch
- B. Fuse – 2 AMP 250V
- C. Counter (Press RED button to reset)
- D. Tab Feed – ON/OFF
- E. Media Feed – ON/OFF

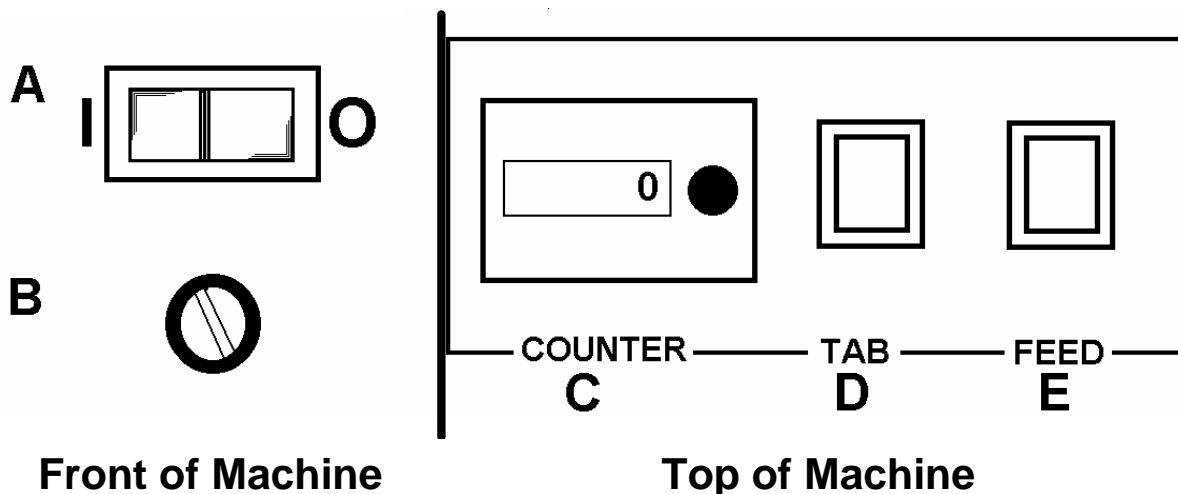

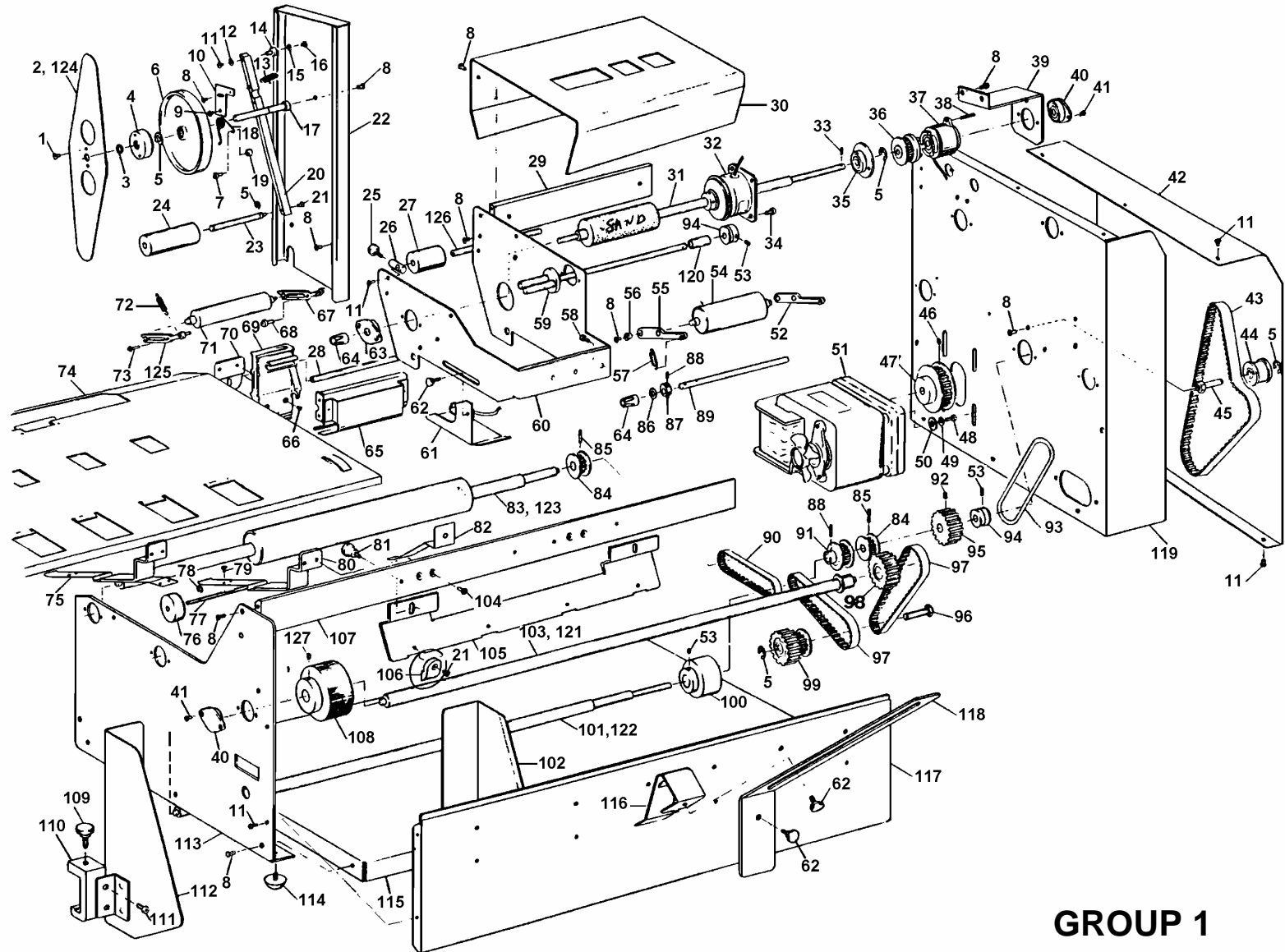

GROUP 1

KEY#	PART #	DESCRIPTION	QTY.	KEY#	PART #	DESCRIPTION	QTY.
1.	123-0446	SCREW, 8-32 X 5/16 PH. HD.	2	37.	62-500-14	CLUTCH ASSY.	1
2.	62-107-14	SIDE GUIDE, REEL	1	38.	123-0018	ROLL PIN 1/8 X 3/4	1
3.	123-0621	O-RING, LUTZ #107-B46A	1	39.	62-103-08	CLUTCH SHAFT SUPPORT	1
4.	90-106-14	HUB, REEL	1	40.	90-103-52	HOUSING ASSY, BALL BEARING	6
5.	123-0081	TRUARC, # 5133 X0025SP	6	41.	123-0566	SCREW, 6-32 X 1/4 FLAT PH.	20
6.	90-106-05	HOLD DOWN STACKER WHEEL	1	42.	62-100-35	SIDE FRAME COVER RIGHT	1
7.	123-0008	SCREW, BUTN. HD. PH. 10-32 X1/2	1	43.	123-0873	TIMING BELT 160 XL037B	1
8.	123-0017	SCREW, TRUSS HD. PH. 10-32 X 1/4	47	44.	62-100-42	ROLLER ASSY., TENSIONER	1
9.	123-0875	SCREW, 10-32 X 1/4 UNDERCUT	1	45.	62-103-47	PIVOT	1
10.	62-107-23	REEL LINK ASSY.	1	46.	123-0709	SET SCREW, 10-24 X 3/8	1
11.	123-0612	SCREW, 6-32 X 1/4 PAN HEAD	26	47.	62-100-43	MOTOR PULLEY ASSY, 26TEETH	1
12.	123-0262	WASHER, #10	1	48.	123-0004	SCREW, SOC. HD. 10-32 X 5/8	4
13.	90-103-70	SPRING, PRESSURE ROLLER	1	49.	123-0068	WASHER, PLAIN #10	4
14.	62-107-07	PIVOT, REEL	1	50.	123-0311	WASHER, 9/32 X 3/4 X1/16 PLASTIC	8
15.	123-0252	WASHER, #6 STAR	1	51.	62-500-15	MOTOR ASSEMBLY	1
16.	123-0274	SCREW, TRUSS HD. PH. 6-32 X 3/8	1	52.	90-103-35	ARM ASSY.	1
17.	62-107-05	STUD, SPOOL SUPPORT	1	53.	123-0322	SET-SCREW, 8-32 X 1/4	8
18.	90-106-07	REEL BRAKE SPRING	1	54.	62-108-10	ROLLER, TAKE-UP PRESSURE	1
19.	62-107-06	SPACER, REEL	1	55.	90-103-35	ARM ASSY.	1
20.	62-107-02	ARM ASSY., REEL	1	56.	62-108-09	PIN	1
21.	123-0683	SCREW, 6-32 X 5/16 PH. FLT-HD.	5	57.	62-108-30	SPRING, PRESSURE ROLLER	2
22.	62-107-01E	STAND ASSY., REEL	1	58.	123-0434	SCREW, 10-32 X 5/16 SOCKET CAP	2
23.	62-107-15	ROLLER SHAFT, REEL	1	59.	62-109-01	WELDMENT, PAPER TAKE-UP SHAFT	1
24.	90-106-11	PLASTIC ROLLER	1	60.	62-108-01E	WELDMENT, APPLICATOR HEAD	1
25.	62-108-21	KNOB ASSY	2	61.	62-108-22	WELDMENT, MEDIA SENSOR BRACKET	1
26.	62-108-13	TAB GUIDE	2	62.	62-100-50	THUMBSCREW ASSY.	5
27.	62-108-14	ROLLER TAB GUIDE	1	63.	90-102-28	HOUSING, BALL BEARING ASSY.	1
28.	62-108-12	APPLICATOR HEAD ROD	2	64.	62-312-07	KNOB, TAB ADVANCE	2
29.	62-100-28	APPLICATOR HEAD SUPPORT	1	65.	62-108-04	WELDMENT, TAB SEPARATOR	1
30.	62-100-18	HEAD SUPPORT COVER W/SILK SCREEN	1	66.	123-0675	SCREW, 6-32 FL. HD. W/UNDERCUT	2
31.	62-103-01	TAB PULL ROLLER ASSY.	1	67.	62-108-19	HOLDER ASSY. R/H, APPL. ROLLER	1
32.	62-500-13	BRAKE ASSEMBLY	1	68.	62-308-11	STUD, APPLICATOR ROLLER	2
33.	123-0369	ROLL PIN 0.093 X 3/8	1	69.	62-104-24	LABEL SENSOR ASSY. FOR ATS-8000	1
34.	123-0876	SCREW, 1/4-28 X 1/4 SOCKET HD. CAP	4	70.	62-108-15	SPRING, TAB GUIDE WELDMENT	1
35.	62-100-46	HOUSING-BALL BEARING	1	71.	62-108-08	ROLLER, APPLICATOR HEAD	1
36.	62-103-13	CLUTCH COUPLING ASSY.	1	72.	62-108-18	SPRING	2

GROUP 1

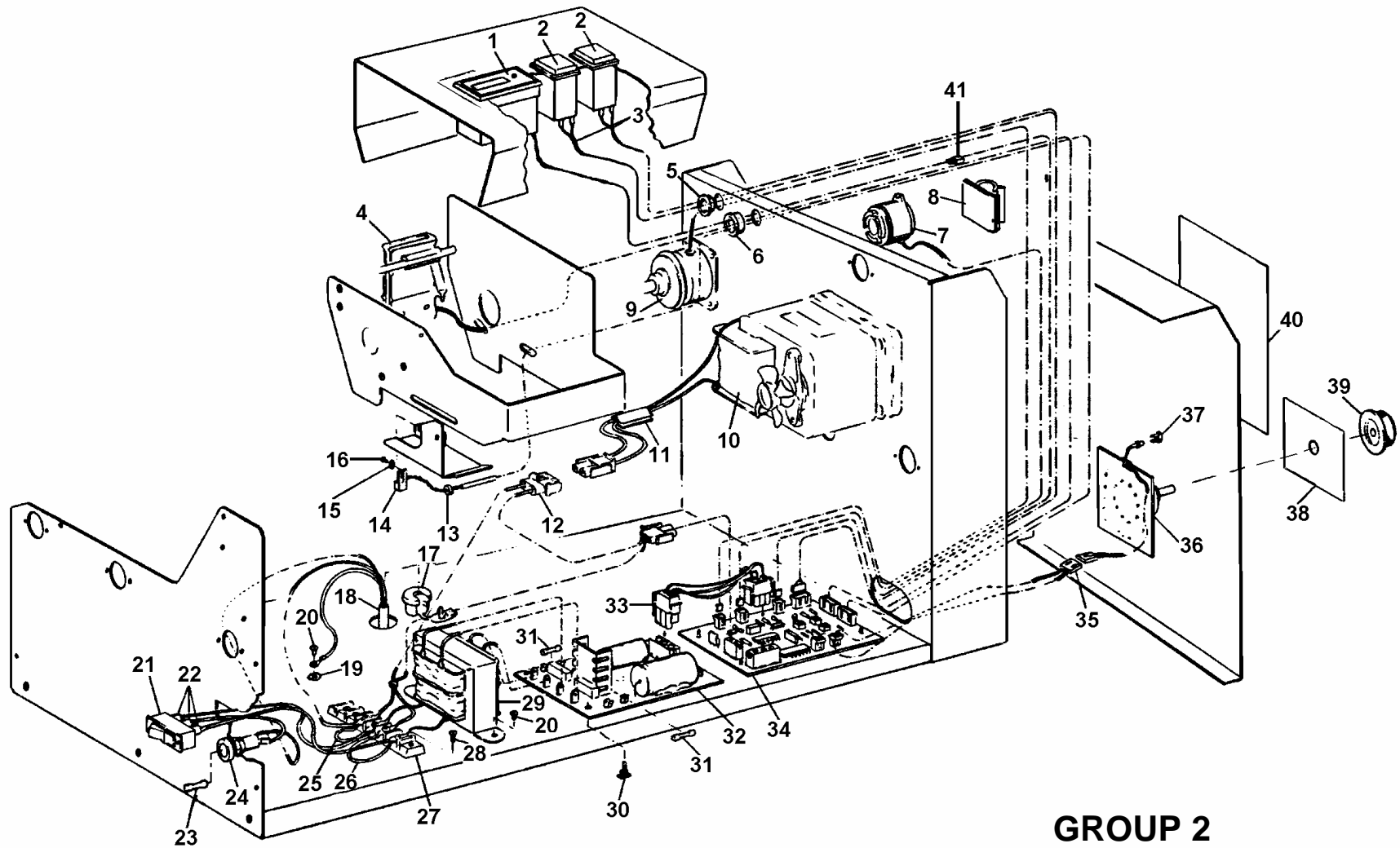

KEY#	PART NUMBER	DESCRIPTION	QTY.	KEY#	PART NUMBER	DESCRIPTION	QTY.
1.	62-500-08	COUNTER ASSY.	1	22.	62-500-11	WIRE HARNESS, POWER SWITCH	1
2.	123-0353	SWITCH FEED/TAB	2	23.	123-0285	FUSE, 2A/250V	1
3.	62-500-10	WIRE HARNESS – SWITCHES	1	24.	123-0355	FUSE HOLDER	1
4.	62-104-24	LABEL SENSOR ASSY. FOR ATS-8000	1	25.	123-0946	JUMPER, TERMINAL BLOCK	1
5.	123-0683	SCREW, 6-32 X 5/16 PH. FLT-HD	1	26.	123-0946	JUMPER, TERMINAL BLOCK	1
6.	123-0892	SNAP-IN BUSHING, 0.550 OD	1	27.	123-0304	TERMINAL BLOCK, 6 TERMINALS	1
7.	62-500-14	CLUTCH ASSEMBLY	1	28.	123-0280	SCREW, 6-32 X 3/8	2
8.	123-0608	CABLE HOLDER	2	29.	62-500-01	TRANSFORMER ASSY.	1
9.	62-500-13	BRAKE ASSEMBLY	1	30.	123-0426	SUPPORT, CIRCUIT BOARD	8
10.	62-500-15	MOTOR ASSEMBLY	1	31.	123-0871	FUSE, 1/2 A - 5X20 MM	2
11.	123-0609	CABLE HOLDER 1/4 IN	2	32.	95-100-20	POWER SUPPLY BOARD	1
12.	62-500-04	WIRE HARNESS - MOTOR	1	33.	62-500-05	WIRE HARNESS - POWER SUPPLY	1
13.	123-0113	TIE, PLASTIC	1	34.	62-100-00	CONTROLLER BOARD	1
14.	62-500-12	WIRE HARNESS, MEDIA SENSOR	1	35.	62-500-03	WIRE HARNESS SET-UP SWITCH	1
15.	123-0252	WASHER, STAR #6	1	36.	62-500-02	SET-UP SWITCH ASSY.	1
16.	123-0021	SCREW, BTN. HD PHIL 4-40 X 1/8	1	37.	123-0685	LED HOLDER	1
17.	123-0301	STRAIN RELIEF	1	38.	90-105-11	DECAL, SENSOR ADJUSTMENT SWITCH	1
18.	123-0173	POWER CORD, 6 FT.	1	39.	123-0390	KNOB, SPEED CONTROL	1
19.	123-0237	WASHER, STAR #10	1	40.	90-105-10	DECAL, SENSOR ADJUSTMENT INSTR.	1
20.	123-0017	SCREW, TRUSS HD. PHIL. 10-32 X 1/4	3	41.	62-500-09	WIRE HARNESS, COUNTER EXTENSION	1
21.	123-0664	SWITCH, MAIN POWER	1				

GROUP 2

INDEX

PART #	KEY	GROUP	PART #	KEY	GROUP	PART #	KEY	GROUP
123-0002	104	1	123-0871	31	2	62-107-07	14	1
123-0004	48	1	123-0875	9	1	62-107-13	124	1
123-0008	7	1	123-0876	34	1	62-107-14	2	1
123-0017	8	1	123-0878	111	1	62-107-15	23	1
123-0017	20	2	123-0892	6	2	62-107-23	10	1
123-0018	38	1	123-0906	93	1	62-108-01E	60	1
123-0021	16	2	123-0946	25	2	62-108-04	65	1
123-0036	85	1	123-0946	26	2	62-108-07	89	1
123-0068	49	1	123-1861	127	1	62-108-08	71	1
123-0080	78	1	56-101-02	100	1	62-108-09	56	1
123-0081	5	1	62-100-00	34	2	62-108-10	54	1
123-0113	13	2	62-100-04E	119	1	62-108-12	28	1
123-0138	97	1	62-100-05E	113	1	62-108-13	26	1
123-0173	18	2	62-100-07E	115	1	62-108-14	27	1
123-0237	19	2	62-100-08	74	1	62-108-15	70	1
123-0252	15	1	62-100-10	117	1	62-108-18	72	1
123-0252	15	2	62-100-18	30	1	62-108-19	67	1
123-0262	12	1	62-100-28	29	1	62-108-20	125	1
123-0267	73	1	62-100-29	109	1	62-108-21	25	1
123-0274	16	1	62-100-30	107	1	62-108-22	61	1
123-0280	28	2	62-100-31	110	1	62-108-25	126	1
123-0285	23	2	62-100-32	80	1	62-108-30	57	1
123-0298	92	1	62-100-35	42	1	62-109-01	59	1
123-0301	17	2	62-100-36	77	1	62-109-05	120	1
123-0304	27	2	62-100-37	76	1	62-110-01	118	1
123-0311	50	1	62-100-38	105	1	62-300-39	82	1
123-0322	53	1	62-100-42	44	1	62-308-11	68	1
123-0353	2	2	62-100-43	47	1	62-312-07	64	1
123-0355	24	2	62-100-46	35	1	62-500-01	29	2
123-0369	33	1	62-100-50	81	1	62-500-02	36	2
123-0390	39	2	62-101-01	121	1	62-500-03	35	2
123-0426	30	2	62-101-03	98	1	62-500-04	12	2
123-0434	58	1	62-101-06	103	1	62-500-05	33	2
123-0446	1	1	62-102-00	122	1	62-500-08	1	2
123-0461	79	1	62-102-08	101	1	62-500-09	41	2
123-0523	86	1	62-102-11	91	1	62-500-10	3	2
123-0566	41	1	62-102-19	95	1	62-500-11	22	2
123-0576	90	1	62-103-01	31	1	62-500-12	14	2
123-0595	32	1	62-103-08	39	1	62-500-13	9	2
123-0608	8	2	62-103-13	36	1	62-500-14	7	2
123-0609	11	2	62-103-47	45	1	62-500-14	37	1
123-0612	11	1	62-104-01	75	1	62-500-15	51	1
123-0620	114	1	62-104-24	69	1	62-500-15	10	2
123-0621	3	1	62-104-24	4	2	71-109-07	62	1
123-0664	21	2	62-105-03	112	1	71-122-06	84	1
123-0675	66	1	62-105-04	102	1	90-102-13	116	1
123-0683	21	1	62-106-01	123	1	90-102-21	108	1
123-0683	5	2	62-106-02	83	1	90-102-28	63	1
123-0685	37	2	62-107-01E	22	1	90-103-09	106	1
123-0695	88	1	62-107-02	20	1	90-103-35	52	1
123-0709	46	1	62-107-05	17	1	90-103-35	55	1
123-0873	43	1	62-107-06	19	1	90-103-40	87	1

INDEX

PART#	KEY	GROUP
90-103-35	55	1
90-103-40	87	1
90-103-35	55	1
90-103-40	87	1
90-103-45	94	1
90-103-52	40	1
90-103-70	13	1
90-105-10	40	2
90-105-11	38	2
90-106-05	6	1
90-106-07	18	1
90-106-11	24	1
90-106-14	4	1
90-107-05	99	1
90-107-06	96	1
95-100-20	32	2



ASTRO
MACHINE CORP.

Copyright © 2007 Astro Machine Corporation
Elk Grove Village, Illinois 60007
10/29/2007

PART NUMBER: 400-ATS8000 REV D